



VisionREADER 2300

2D code reader



Dimensioned drawing

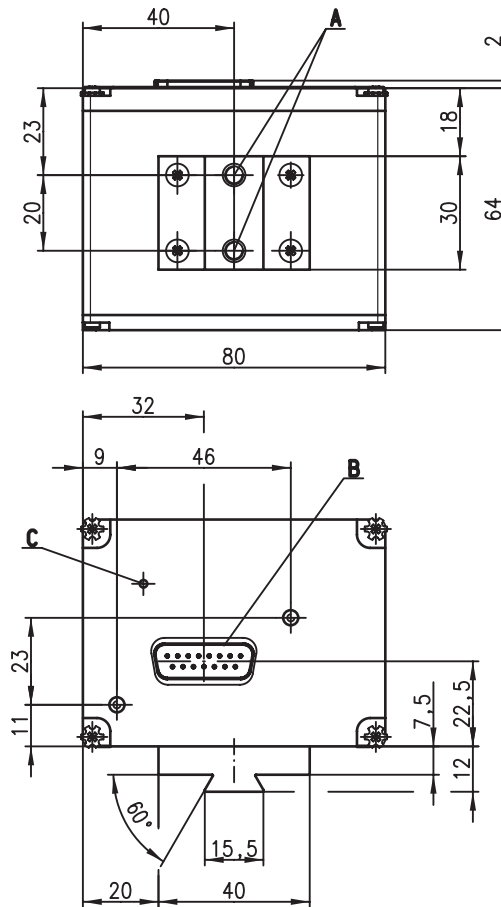

- A For screw M6x8
- B 15-pin sub-D connector
- C LED green/red

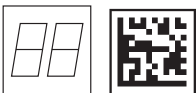

- Code reader for Data-Matrix codes, bar codes etc.
- High resolution for parts and labels directly marked
- External trigger possible
- Built-in decoder
- Read-display
- RS 232 interface
- Operating temperature from 5 through 40°C



Electrical connection

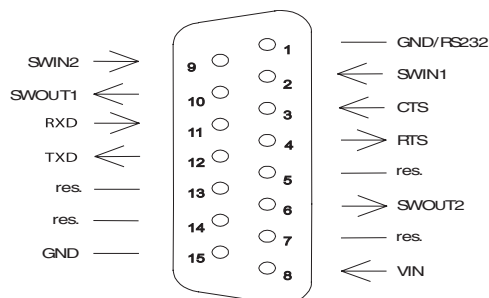

Accessories

- **MA 2** Part No. 500 31256
Modular connector unit
- **MA 2 L** Part No. 500 36186
Modular connector unit
- **MA 42 DP-k** Part No. 500 35298
Modular connector unit for Profibus
- **KB 031-3000** Part No. 500 35355
Connection cable for MA 2 and MA 42 DP-k
- **KB 040-3000** Part No. 500 26658
Connection cable for MA 2 L
- **BT 56** Part No. 500 27375
Mounting bracket for rod

We reserve the right to make changes • db_vr2300_e.fm



Specifications

Electrical data

Operating voltage U_B 10 ... 30VDC
Current 600mA

Interfaces

Interface type RS 232 (Host) for code output
Connections 2 electrically insulated inputs
2 electrically insulated outputs
Trigger serial or digital input

Code types

Code types Data Matrix ECC 200 (10x10 to 64x64)
bar codes: 2/5 Interleaved, UPC/EAN/JAN, Code 39,
Code 128
Read direction omnidirectional, various tilt and rotational
angles up to 20°

Optical Data

Optical system CMOS 800x600 pixel
Contrast 15% (black/white)
Light source integrated LED (flash/continued)
Point of focus VR 2300 S M 100 55mm
VR 2300 S F 100 80mm
VR 2300 S L 100 130mm

Mechanical data

Housing diecast aluminium
Protection class IP 65
Weight 400 g
Dimensions 80x60x64mm
Fastening 2xM6 screws, dovetail

Environmental data

Ambient temp. (operation) 5°C ... +40°C
Relative air humidity 5 to 90% (non-condensing)

Tables

Diagrams

Ordering guide

2D code reader

VisionREADER 2300 S M 100
VisionREADER 2300 S F 100
VisionREADER 2300 S L 100

Part No.

500 39357
500 39358
500 40918

Remarks

2D code reader in metal housing (IP 65) with integrated high-power decoder (300 MIPS) data transmission via programmable RS 232 interface for industrial use.